

光滑極限栓規

定制檢規
 可定制其它等級, 如H8, H9, G7
 可定制直徑, 如19.003mm
 可定制長度, 如70mm

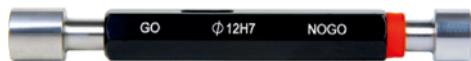

- 包含通規和止規
- 等級H7
- 硬度HRC60±2
- 符合DIN7150-2

4124-12

H7尺寸公差

| 直徑(mm) | 類型 | Ød1 通規尺寸公差 (mm) | Ød2 止規尺寸公差 (mm) | L1 | L2 | L | S1, S2 |
|-----------|----|-----------------|-----------------|-----|-----|-----|----------|
| ≥2, ≤3 | A | +0.0010/+0.0022 | +0.0088/+0.010 | 6.5 | 4.5 | 62 | - |
| >3, ≤6 | A | +0.0013/+0.0027 | +0.0106/+0.012 | 8 | 6 | 74 | - |
| >6, ≤10 | A | +0.0015/+0.0033 | +0.0132/+0.015 | 10 | 7 | 87 | - |
| >10, ≤14 | A | +0.0018/+0.0038 | +0.0160/+0.018 | 12 | 8 | 99 | - |
| >14, ≤18 | A | +0.0018/+0.0038 | +0.0160/+0.018 | 14 | 10 | 114 | - |
| >18, ≤24 | A | +0.0023/+0.0046 | +0.0186/+0.021 | 16 | 12 | 132 | - |
| >24, ≤30 | A | +0.0023/+0.0046 | +0.0186/+0.021 | 18 | 14 | 136 | - |
| >30, ≤40 | A | +0.0023/+0.0055 | +0.0220/+0.025 | 20 | 15 | 155 | - |
| >40, ≤50 | A | +0.0023/+0.0055 | +0.0220/+0.025 | 25 | 18 | 169 | - |
| >50, ≤65 | B | +0.0028/+0.0064 | +0.0264/+0.030 | 30 | 18 | - | 164, 152 |
| >65, ≤80 | B | +0.0028/+0.0064 | +0.0264/+0.030 | 35 | 25 | - | 169, 159 |
| >80, ≤100 | B | +0.0032/+0.0075 | +0.0308/+0.035 | 35 | 25 | - | 169, 159 |



A型

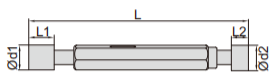

A型



B型

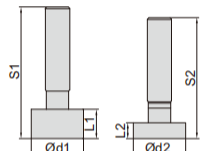

B型

| 型號 | 直徑Ød | 類型 |
|---------|------|----|
| 4124-2 | 2 | A |
| 4124-3 | 3 | A |
| 4124-4 | 4 | A |
| 4124-5 | 5 | A |
| 4124-6 | 6 | A |
| 4124-7 | 7 | A |
| 4124-8 | 8 | A |
| 4124-9 | 9 | A |
| 4124-10 | 10 | A |
| 4124-11 | 11 | A |
| 4124-12 | 12 | A |
| 4124-13 | 13 | A |
| 4124-14 | 14 | A |
| 4124-15 | 15 | A |
| 4124-16 | 16 | A |

(mm)

| 型號 | 直徑Ød | 類型 |
|---------|------|----|
| 4124-17 | 17 | A |
| 4124-18 | 18 | A |
| 4124-19 | 19 | A |
| 4124-20 | 20 | A |
| 4124-21 | 21 | A |
| 4124-22 | 22 | A |
| 4124-23 | 23 | A |
| 4124-24 | 24 | A |
| 4124-25 | 25 | A |
| 4124-26 | 26 | A |
| 4124-27 | 27 | A |
| 4124-28 | 28 | A |
| 4124-29 | 29 | A |
| 4124-30 | 30 | A |
| 4124-31 | 31 | A |

(mm)

| 型號 | 直徑Ød | 類型 |
|---------|------|----|
| 4124-32 | 32 | A |
| 4124-33 | 33 | A |
| 4124-34 | 34 | A |
| 4124-35 | 35 | A |
| 4124-36 | 36 | A |
| 4124-37 | 37 | A |
| 4124-38 | 38 | A |
| 4124-39 | 39 | A |
| 4124-40 | 40 | A |
| 4124-41 | 41 | A |
| 4124-42 | 42 | A |
| 4124-43 | 43 | A |
| 4124-44 | 44 | A |
| 4124-45 | 45 | A |
| 4124-46 | 46 | A |

(mm)

| 型號 | 直徑Ød | 類型 |
|----------|------|----|
| 4124-47 | 47 | A |
| 4124-48 | 48 | A |
| 4124-49 | 49 | A |
| 4124-50 | 50 | A |
| 4124-52 | 52 | B |
| 4124-55 | 55 | B |
| 4124-60 | 60 | B |
| 4124-65 | 65 | B |
| 4124-70 | 70 | B |
| 4124-75 | 75 | B |
| 4124-80 | 80 | B |
| 4124-85 | 85 | B |
| 4124-90 | 90 | B |
| 4124-95 | 95 | B |
| 4124-100 | 100 | B |

(mm)